

1281 Dome head CU-A2 closed rivet, closed blind rivet, closed pop rivet

Rivet body: Copper
Mandrel: Stainless steel (A2)

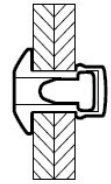
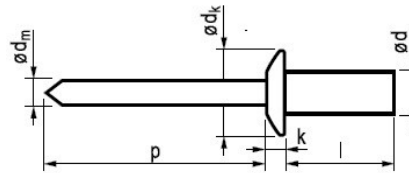

Ød * Drill hole mm	l: length (mm) +1/-0,2	Grip range mm	Part no.	Ødk mm	k mm	Ødm mm	p mm	Tensile Newton	Shear Newton	Description
3,2 [+0,08/-0,1] Ø 3,3	6,5	0,5-1,5	1281-3206	6,0 [+/-0,24]	≤1,4	~1,70	≥27	1300	850	3,2*6 Dome head Copper/Inox closed rivet
	8,0	1,0-3,0	1281-3208							3,2*8 Dome head Cu/A2 waterproof rivet
	9,5	2,5-4,5	1281-3209							3,2*9 Dome head Cu/A2 closed pop rivet
	12,5	5,5-7,5	1281-3212							3,2*12 Dome head Cu/A2 closed blind rivet
4,0 [+0,08/-0,1] Ø 4,1	8,0	0,5-3,0	1281-4008	8,0 [+/-0,29]	≤1,7	~2,18	≥27	2000	1350	4,0*8 Dome head Copper/Inox closed rivet
	10,0	3,0-5,0	1281-4010							4,0*10 Dome head Cu/A2 waterproof rivet

Technical specifications:

- after riveting the stem/mandrel of rivet fixed in the rivet body
- airtight and waterproof (extra safe if used with silicone)
- it is good till 35 bar of pressure
- it has stronger shear/tensile strength as the regular rivets
- for tinsmiths
- solderable

