

1034 Countersunk head AL-ST rivet (ASF), blind rivet, pop rivet

DIN: 7337B
 DIN EN ISO: 15978
 Rivet body: Aluminum (AlMg2,5/3,5)
 Mandrel: Steel, RoHS surface treatment

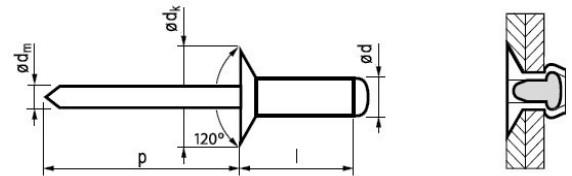

$\varnothing d$ * Drill hole mm	l: length (mm) +1/-0,2	Grip range mm	Part no.	$\varnothing d_k$ mm	k mm	$\varnothing d_m$ mm	p mm	Tensile Newton	Shear Newton	Description
2,4 [+0,08/-0,10] *Ø 2,5	6,0	2,0-4,0	1034-2406	5,0 [+0/-0,4]	-	~1,45	≥27	355	315	2,4*6 Countersunk head Al/St (ASF) rivet
	8,0	4,0-6,0	1034-2408							2,4*8 Countersunk head Al/St (ASF) pop rivet
	10,0	6,0-8,0	1034-2410							2,4*10 Countersunk head Al/St (ASF) blind rivet
3,0 [+0,08/-0,10] *Ø 3,1	6,0	1,5-3,5	1034-3006	6,0 [+0/-0,4]	-	~1,75	≥27	810	620	3,0*6 Countersunk head Al/St (ASF) pop rivet
	8,0	3,5-5,5	1034-3008							3,0*8 Countersunk head Al/St (ASF) blind rivet
	10,0	5,5-7,5	1034-3010							3,0*10 Countersunk head Al/Steel rivet
	12,0	7,5-9,5	1034-3012							3,0*12 Countersunk head Al/St (ASF) rivet
3,2 [+0,08/-0,10] *Ø 3,3	6,0	1,5-3,5	1034-3206	6,0 [+0/-0,4]	-	~1,75	≥27	980	760	3,2*6 Countersunk head Al/St (ASF) pop rivet
	8,0	3,5-5,5	1034-3208							3,2*8 Countersunk head Al/St (ASF) blind rivet
	10,0	5,5-7,5	1034-3210							3,2*10 Countersunk head Al/Steel rivet
	12,0	7,5-9,5	1034-3212							3,2*12 Countersunk head Al/St (ASF) rivet
	14,0	9,5-11,5	1034-3214							3,2*14 Countersunk head Al/St (ASF) pop rivet
4,0 [+0,08/-0,15] *Ø 4,1	6,0	1,5-3,0	1034-4006	7,5 [+0/-0,5]	-	~2,10	≥27	1600	1200	4,0*6 Countersunk head Al/St (ASF) blind rivet
	8,0	3,0-5,0	1034-4008							4,0*8 Countersunk head Al/Steel rivet
	10,0	5,0-6,5	1034-4010							4,0*10 Countersunk head Al/St (ASF) rivet
	12,0	6,5-8,6	1034-4012							4,0*12 Countersunk head Al/St (ASF) pop rivet
	14,0	8,5-10,5	1034-4014							4,0*14 Countersunk head Al/St (ASF) blind rivet
	16,0	10,5-12,5	1034-4016							4,0*16 Countersunk head Al/Steel rivet
4,8 [+0,08/-0,15] *Ø 4,9	8,0	3,0-4,5	1034-4808	9,0 [+0/-0,5]	-	~2,70	≥27	2 230	1 690	4,8*8 Countersunk head Al/St (ASF) rivet
	10,0	4,5-6,0	1034-4810							4,8*10 Countersunk head Al/St (ASF) pop rivet
	12,0	6,0-8,0	1034-4812							4,8*12 Countersunk head Al/St (ASF) blind rivet
	14,0	8,0-10,0	1034-4814							4,8*14 Countersunk head Al/Steel rivet
	16,0	10,0-12,0	1034-4816							4,8*16 Countersunk head Al/St (ASF) rivet
	18,0	12,0-14,0	1034-4818							4,8*18 Countersunk head Al/St (ASF) pop rivet
	20,0	14,0-16,0	1034-4820							4,8*20 Countersunk head Al/St (ASF) blind rivet
	25,0	18,0-21,0	1034-4825							4,8*25 Countersunk head Al/Steel rivet
5,0 [+0,08/-0,15] *Ø 5,1	8,0	3,0-4,5	1034-5008	9,0 [+0/-0,5]	-	~2,70	≥27	2 500	2 000	5,0*8 Countersunk head Al/St (ASF) rivet
	10,0	4,5-6,0	1034-5010							5,0*10 Countersunk head Al/St (ASF) pop rivet
	12,0	6,0-8,0	1034-5012							5,0*12 Countersunk head Al/St (ASF) blind rivet
	14,0	8,0-10,0	1034-5014							5,0*14 Countersunk head Al/Steel rivet
	16,0	10,0-12,0	1034-5016							5,0*16 Countersunk head Al/St (ASF) pop rivet
	18,0	12,0-14,0	1034-5018							5,0*18 Countersunk head Al/St (ASF) blind rivet
	21,0	14,0-17,0	1034-5020							5,0*20 Countersunk head Al/Steel rivet
	25,0	17,0-20,0	1034-5025							5,0*25 Countersunk head Al/St (ASF) rivet

Technical specifications:

- after riveting the stem/mandrel of rivet is not fixed in the rivet body necessarily
- due to the countersunk head it remains in the level of the sheet

